

| ITEM |  |  |  | P/N      |  |  |  | DESCRIPTION                              | QTY | REV  |  |  |  | DESCRIPTION | Drawn                  | APPR     |          |
|------|--|--|--|----------|--|--|--|--|-----|------|--|--|--|-------------|------------------------|----------|----------|
| 1    |  |  |  | 6500-898 |  |  |  | IPB-Model 6500-098                       | 1   | EO   |  |  |  | REV         | Item 43 Was: 1601-041. | Sal      | D.C.     |
| 2    |  |  |  | 6500-150 |  |  |  | Base Stand                               | 1   | ---- |  |  |  | B           |                        | 10/30/08 | 10/30/08 |
| 3    |  |  |  | 6500-100 |  |  |  | Box Control                              | 1   |      |  |  |  |             |                        |          |          |
| 4    |  |  |  | 6500-105 |  |  |  | Bracket Switch Box                       | 1   |      |  |  |  |             |                        |          |          |
| 6    |  |  |  | 2600-706 |  |  |  | Gearbox                                  | 1   |      |  |  |  |             |                        |          |          |
| 7    |  |  |  | 6500-115 |  |  |  | Collar Limit Switch Mount                | 1   |      |  |  |  |             |                        |          |          |
| 8    |  |  |  | 6500-030 |  |  |  | Bracket-Plastic Limit Switch, Lower      | 1   |      |  |  |  |             |                        |          |          |
| 9    |  |  |  | 1601-263 |  |  |  | Switch-Mag Sensor (Yel/Wht or Yel/Slate) | 1   |      |  |  |  |             |                        |          |          |
| 10   |  |  |  | 6500-032 |  |  |  | Bracket-Plastic Limit Switch, Upper      | 1   |      |  |  |  |             |                        |          |          |
| 11   |  |  |  | 1601-261 |  |  |  | Switch-Mag Sensor (Blu/Wht or Orn/Slate) | 1   |      |  |  |  |             |                        |          |          |
| 12   |  |  |  | 6500-135 |  |  |  | Bushing Bronze 1 1/8 ID                  | 1   |      |  |  |  |             |                        |          |          |
| 13   |  |  |  | 6500-410 |  |  |  | Sub Assy-Hub 1 HP                        | 1   |      |  |  |  |             |                        |          |          |
| 14   |  |  |  | 2343-010 |  |  |  | PCB-Current Sensor                       | 1   |      |  |  |  |             |                        |          |          |
| 15   |  |  |  | 2599-063 |  |  |  | Label-8 Position Term                    | 1   |      |  |  |  |             |                        |          |          |
| 16   |  |  |  | 3130-023 |  |  |  | Term Strip 8 Row Screw                   | 1   |      |  |  |  |             |                        |          |          |
| 17   |  |  |  | 3129-008 |  |  |  | Terminal Block Cover 8 Position          | 1   |      |  |  |  |             |                        |          |          |
| 18   |  |  |  | 2600-810 |  |  |  | Bushing 7/8 Poke Thru Flaps              | 10  |      |  |  |  |             |                        |          |          |
| 19   |  |  |  | 1200-028 |  |  |  | Outlet Snap In                           | 3   |      |  |  |  |             |                        |          |          |
| 20   |  |  |  | 6500-200 |  |  |  | Tool-Hub Clutch Release                  | 1   |      |  |  |  |             |                        |          |          |
| 40   |  |  |  | 2600-731 |  |  |  | Gasket Switch Cover                      | 1   |      |  |  |  |             |                        |          |          |
| 41   |  |  |  | 2600-533 |  |  |  | Switch Cover Lockable                    | 1   |      |  |  |  |             |                        |          |          |
| 42   |  |  |  | 1506-071 |  |  |  | Tone Generator Loud                      | 1   |      |  |  |  |             |                        |          |          |
| 43   |  |  |  | 1601-140 |  |  |  | Switch Toggle 2 Pole On-Off              | 1   |      |  |  |  |             |                        |          |          |
| 44   |  |  |  | 1812-005 |  |  |  | Switch Push Button N.O.                  | 2   |      |  |  |  |             |                        |          |          |
| 60   |  |  |  | 2620-411 |  |  |  | Nut Hex Flange Lock 5/16-18              | 10  |      |  |  |  |             |                        |          |          |
| 61   |  |  |  | 2620-409 |  |  |  | Nut Hex Flange Lock 1/4-20               | 8   |      |  |  |  |             |                        |          |          |
| 70   |  |  |  | 2616-018 |  |  |  | Screw Phillips Head 8-32 x 1/2           | 2   |      |  |  |  |             |                        |          |          |
| 71   |  |  |  | 2616-051 |  |  |  | Screw Phillips Head 10-32 x 3/8          | 2   |      |  |  |  |             |                        |          |          |
| 72   |  |  |  | 2616-002 |  |  |  | Screw Phillips Head 6-32 x 1/2           | 8   |      |  |  |  |             |                        |          |          |
| 100  |  |  |  | 9402-053 |  |  |  | Tubing Flex/Split 1/4 OD                 | 2'  |      |  |  |  |             |                        |          |          |
| 101  |  |  |  | 9402-055 |  |  |  | Tubing Flex/Split 1/2 OD                 | 3'  |      |  |  |  |             |                        |          |          |
| 102  |  |  |  | 6500-043 |  |  |  | Wire Set                                 | 1   |      |  |  |  |             |                        |          |          |
| 103  |  |  |  | 6500-044 |  |  |  | Wire Set for Hi Voltage                  | 1   |      |  |  |  |             |                        |          |          |
| 104  |  |  |  | 6500-065 |  |  |  | Installation Manual                      | 1   |      |  |  |  |             |                        |          |          |

(Key)  
(1/4 x 1/4 x 1 3/4)

(Key)  
(1/4 x 1/4 x 1 3/4)

(13)

(20)

(12)

(6)

(10) (11)

(7)

(8) (9)

(2) (1) (This Document)

(3) (60) 4X

Ref (60)

(14) (72) 4X

(15)

(16) (17) (72) 4X

(18) 9X

3X (19)

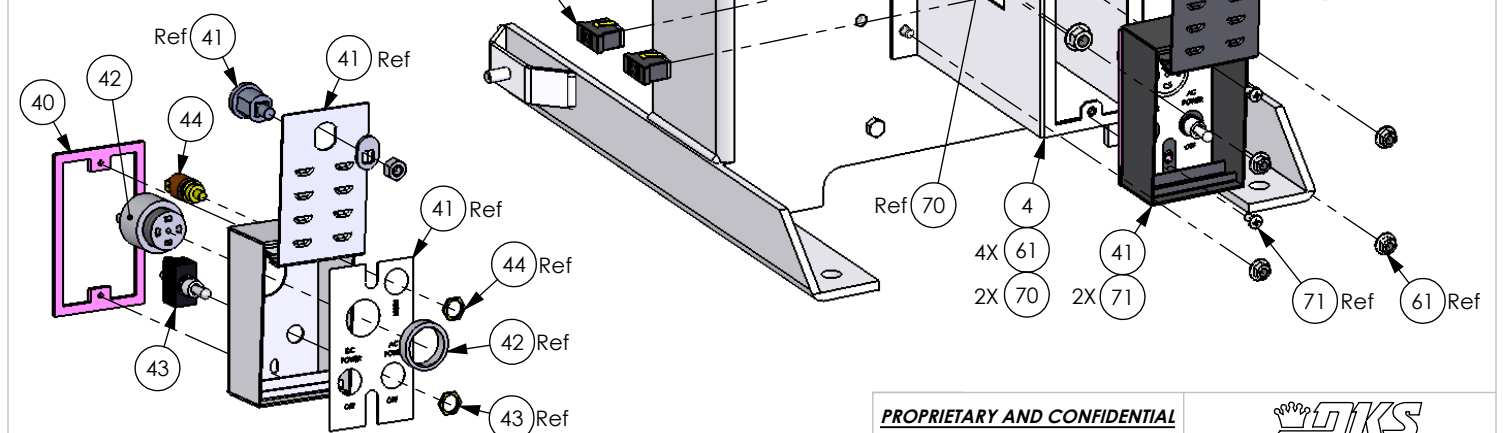

2. Flex Tubing, Manual, & Wire Sets (Items 100-104) Not Shown for Clarity.

1. Reference Movex 6500-098 Rev B when modifying BOM.

Notes: Unless Otherwise Specified.

**PROPRIETARY AND CONFIDENTIAL**

THE INFORMATION CONTAINED IN THIS DRAWING IS THE SOLE PROPERTY OF Door King. ANY REPRODUCTION IN PART OR AS A WHOLE WITHOUT THE WRITTEN PERMISSION OF Door King IS PROHIBITED.

**IPB-Model 6500-098, 460V, 1HP, Xfmr, Master**

|      |          |     |
|------|----------|-----|
| SIZE | DWG NO   | REV |
| A    | 6500-898 | B   |

Scale: None

SHEET 1 OF 4

| ITEM | P/N      | DESCRIPTION                     | QTY |
|------|----------|---------------------------------|-----|
| 50   | 2600-162 | Motor Assembly 1HP Model 630    | 1   |
| 51   | 4001-096 | Transformer 460/230/208-115V    | 1   |
| 54   | 2600-597 | Pulley-13 x 7/8 Cast Iron AK134 | 1   |
| 55   | 6500-047 | Belt-47 4L470                   | 1   |
| 56   | 6500-250 | Base Motor Mount BBU            | 1   |
| 64   | 2902-006 | Nut Nylon Lock 10-32            | 2   |
| 65   | 2620-420 | Nut Hex 1/2-13                  | 5   |
| 66   | 2620-405 | Nut Hex 3/8-16                  | 4   |
| 68   | 2620-328 | Nut Center Lock 5/16-18         | 2   |
| 69   | 2616-097 | Set Screw 5/16-18 x 3/8         | 2   |
| 77   | 2616-058 | Screw Phillips Head 10-32 x 2   | 2   |
| 79   | 2616-438 | Screw-Hex 8-32 x 1/4            | 1   |
| 80   | 2620-050 | Lockwasher 1/2                  | 5   |

| ITEM | P/N      | DESCRIPTION                  | QTY |
|------|----------|------------------------------|-----|
| 81   | 2620-047 | Lockwasher 3/8               | 4   |
| 82   | 2620-019 | Washer 3/8 SAE               | 8   |
| 84   | 2620-053 | Lockwasher 5/16              | 2   |
| 90   | 2615-081 | Bolt Hex Head 1/2-13 x 1 3/4 | 3   |
| 91   | 2615-053 | Bolt Hex Head 3/8-16 x 1 1/4 | 4   |
| 92   | 2615-084 | Bolt Hex Head 1/2-13 x 2 1/2 | 1   |
| 93   | 2615-625 | Bolt Carriage 1/4-20 x 1/2   | 4   |
| 95   | 2615-153 | Bolt Hex Head 5/16-18 x 3/4  | 2   |

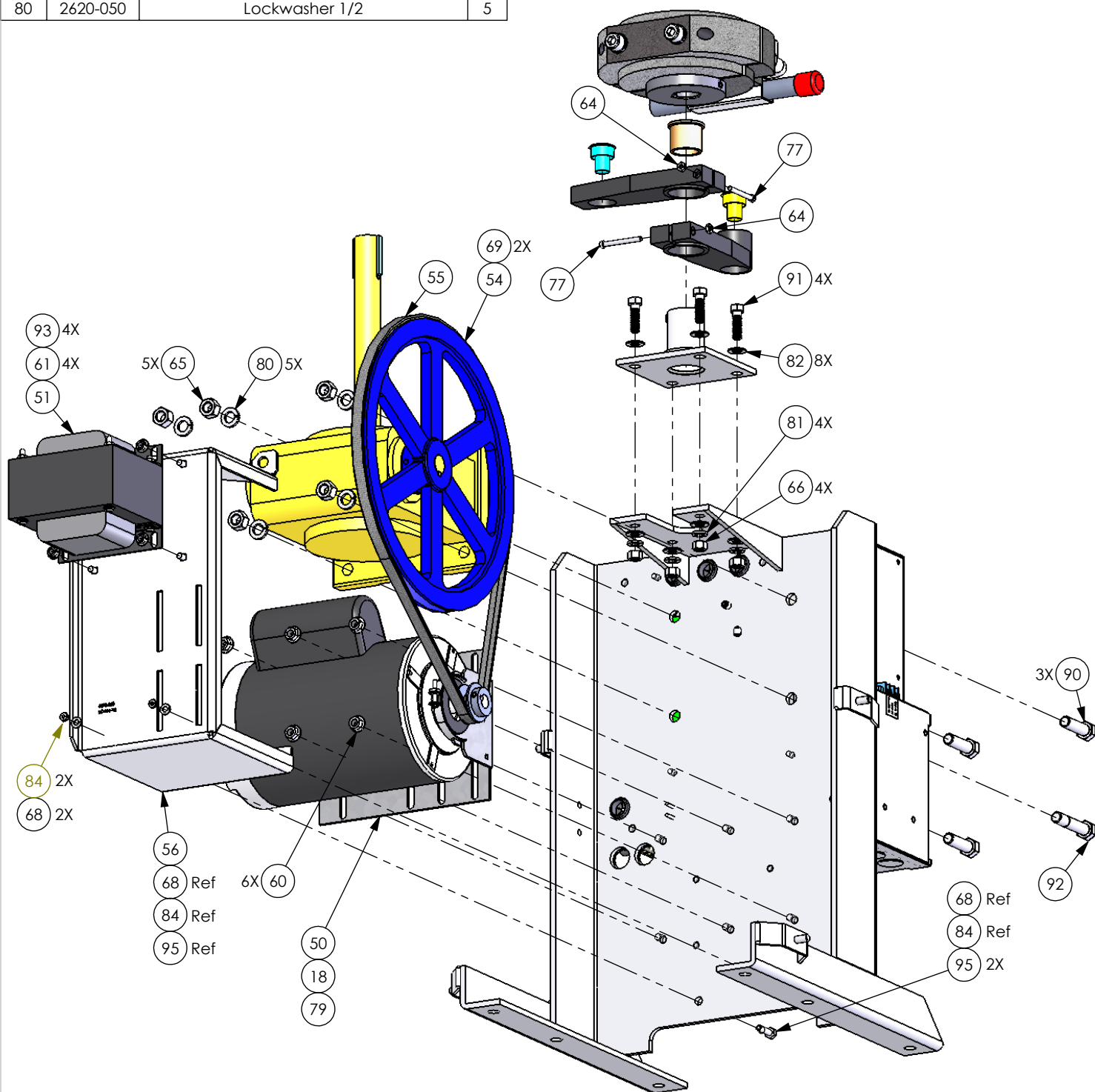

| ITEM | P/N      | DESCRIPTION                     | QTY |
|------|----------|---------------------------------|-----|
| 24   | 4001-020 | Terminal 20 Pin                 | 1   |
| 25   | 4405-010 | PCB Assy-Gate Operator          | 1   |
| 26   | 2600-473 | Marker Strip 460V 3Phase        | 1   |
| 27   | 3130-008 | Terminal Block-5 Position       | 1   |
| 28   | 3129-005 | Terminal Block Cover 5 Position | 1   |
| 30   | 2600-437 | Washer Brass                    | 1   |
| 31   | 2600-413 | Terminal Block-3 Position       | 1   |
| 32   | 2600-619 | Wire Clip-5/8                   | 3   |
| 33   | 2599-038 | Label-Radio 9310                | 1   |

| ITEM | P/N      | DESCRIPTION                       | QTY |
|------|----------|-----------------------------------|-----|
| 34   | 2599-096 | Label Key Model 9310              | 1   |
| 35   | 2599-006 | Decal-Supply Gnd                  | 1   |
| 36   | 2599-014 | Decal-Copper Wire Only            | 1   |
| 37   | 6500-005 | Cover-Plastic, Enclosure          | 1   |
| 62   | 2902-004 | Nut Nylon Lock 8-32               | 4   |
| 73   | 2616-007 | Screw Phillips Head<br>6-32 x 5/8 | 2   |
| 74   | 2616-000 | Screw Phillips Head<br>6-32 x 1/4 | 2   |
| 75   | 2616-003 | Screw Phillips Head<br>6-32 x 3/4 | 4   |
| 76   | 2616-001 | Screw Phillips Head<br>6-32 x 3/8 | 2   |

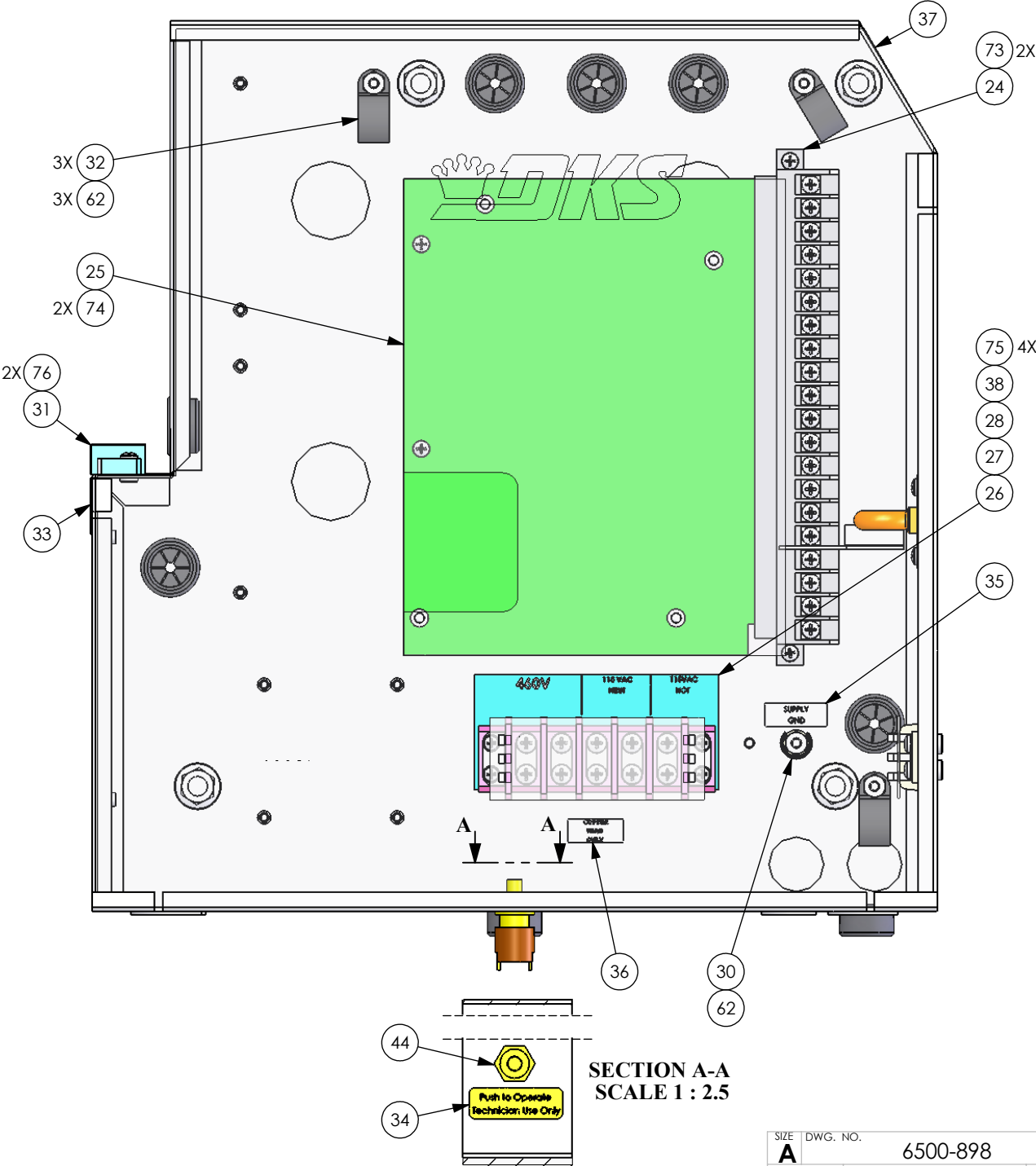

| ITEM | PART NUMBER | DESCRIPTION               | QTY |
|------|-------------|---------------------------|-----|
| 78   | 2616-580    | Nut Barrel 5/16-18 Thread | 4   |
| 85   | 6500-450    | Cover-Front w/ Hardware   | 1   |
| 86   | 6500-460    | Cover-Back w/ Labels      | 1   |
| 87   | 6500-430    | Sub Assy-Arm Main         | 1   |
| 88   | 6500-440    | Sub Assy-Cover Turret     | 1   |

