

TELEPHONE ENTRY SYSTEM HEATER KIT

DoorKing Part Number
2600-584

This kit is designed for DoorKing Telephone Entry Systems. For cold weather climates where temperatures routinely drop below 40°F (4°C). The thermostat will automatically control the temperature inside operator housing.

Installation

This is a typical installation shown for a surface mount telephone entry system. The heater and thermostat are mounted in the flush mount and wall mount units in the same relative positions.

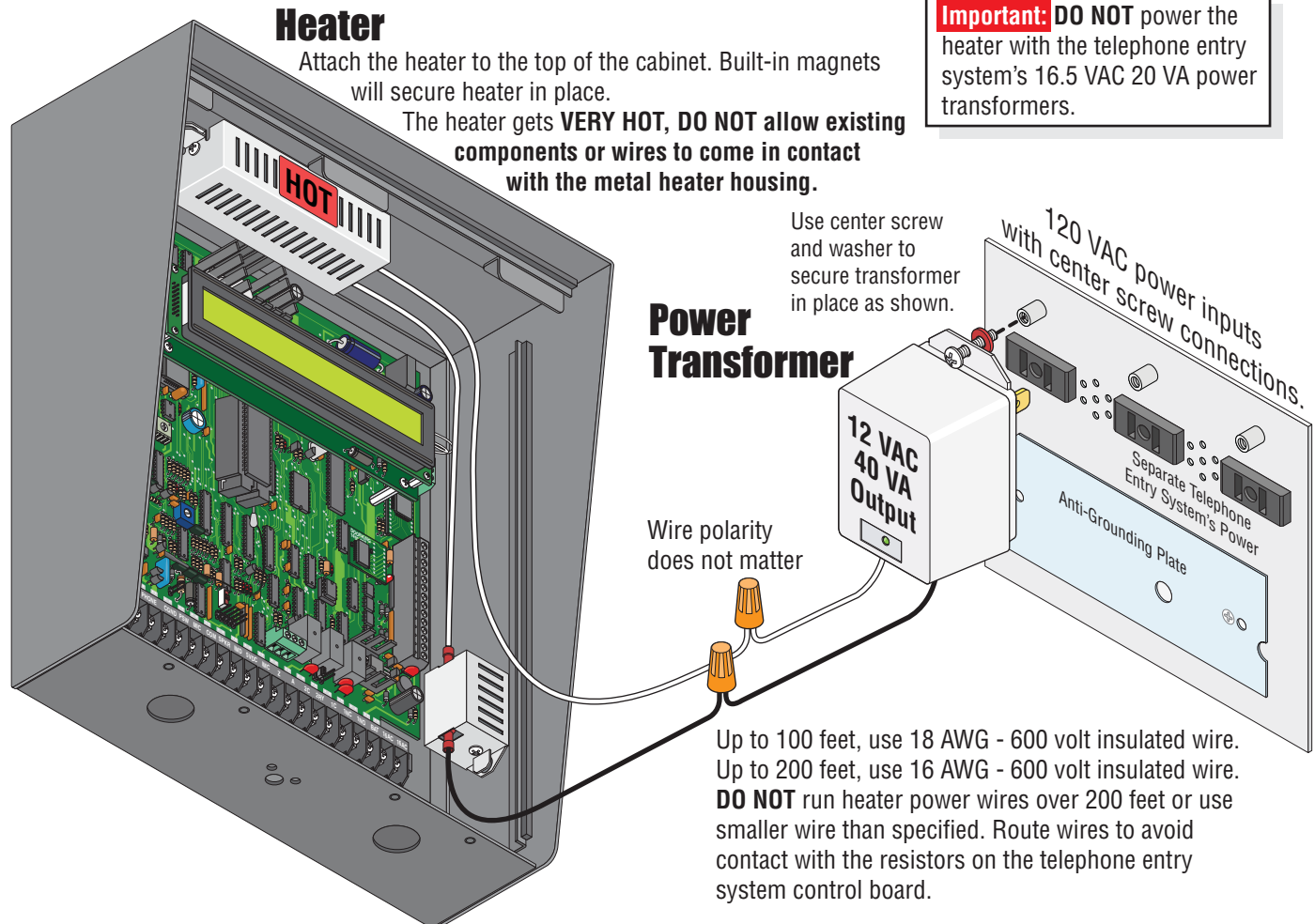

Thermostat

Attach the thermostat on the side near the bottom of the cabinet **as far from heater as possible**. **DO NOT position the thermostat right next to the heater.** Built-in magnets will secure thermostat in place. Thermostat will automatically turn heater on at approximately 40°F (4°C) and off at 55°F (12°C).

Note: Transformer is for indoor use and **MUST** be in a protected enclosure from weather when using outdoors.